

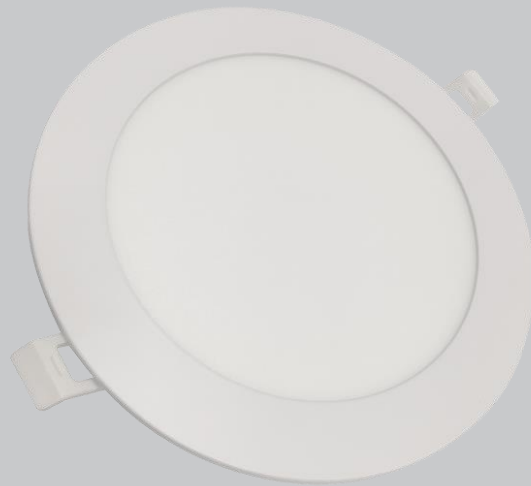

ASTRELIGHTS INC



ETL Recessed Round Pane Light

BQ-YPL-U120-9-T-CCT

BQ-YPL-U175-12-T-CCT

Introduction



CCT Switch Back lighting LED Panel Light can choose between 3000K-6500K color temperature values of 3000K/3500K/4000K/5000K/6500K, which is convenient for consumers to choose the color temperature value they like.

The product has high luminous efficiency, lighter weight, long life, environmental protection and no pollution.

This is our private mode product whose frame, electric wire and driver box are all developed by our company.

We have TRIAC dimmable driver that is compatible with LEVITON and Lutron dimmer .

Features

- Ultra-thin 11mm.
- 5 color temperature switching
- Instant on/off, no noise/UV/light leak/shadow
- Frameless design 120 degree beam angle.
- Support SCR dimming
- Certified : ETL

Application Areas

Office & school lighting: office room, meeting room, class room etc.

Commercial lighting: shoppingmall, super market, retailer shops etc.

Home lighting: Balcony, Bathroom, Restaurant, Kitchen, Corridor etc.

Product Image



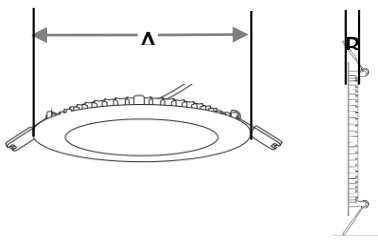

Measurement

| Model | Dimension(mm) | | Cut Size (mm) | Product Weight (Kg) | | Package weight (Kg) | | Carton Size (mm) | Qty/CTN | 20GP (pcs) | 40HQ (pcs) |
|----------------------|---------------|---|---------------|---------------------|--------|---------------------|---------|------------------|---------|------------|------------|
| | A | B | | N.W/PC | G.W/PC | N.W/CTN | G.W/CTN | | | | |
| BQ-YPL-U120-9-T-CCT | Φ120*11 | | Φ105 | 0.22 | 0.27 | 13 | 14.5 | 580*270*320 | 40 | 25000 | 6000 |
| BQ-YPL-U175-12-T-CCT | Φ175*11 | | Φ165 | 0.32 | 0.4 | 12 | 13.8 | 590*320*370 | 30 | 1000 | 3200 |

Technical Data Sheet

| Model No. | BQ-YPL-U120-9-T-CCT | BQ-YPL-U175-12-T-CCT |
|------------------------|--|----------------------|
| Watt(W) | 9W | 12W |
| Dimension(mm) | Φ120*11mm | Φ175*11mm |
| Input Voltage(V) | 100-130V | |
| LED Model | SMD 2835, 0.2W,27-29lm | |
| LED Qty(PCS) | 27*2pcs | 36*2pcs |
| SDCM | / | |
| CCT(K) | 3000K/3500K/4000K/5000K/6500K (CCT Switch) | |
| Efficiency (lm/W) ±5% | 80lm/W | 80lm/W |
| Luminous Flux(lm) ±5% | 750 | 1000 |
| CRI | ≥80 | |
| Beam Angle (°) | 120° | |
| LED Driver | US standard power supply (Compatible with Infineon / Lutron dimmers) | |
| DIM | SCR Dimming | |
| Protection Class | / | |
| IP Rating | IP20 | |
| Material | Aluminum+PMMA+PS | |
| Lifetime (hr) | 50000H | |
| Warrant | 3 years | |
| Operating Temp.(°C) | -20°C ~45°C | |
| Storage Temp.(°C) | -20°C ~65°C | |
| Installation | Recessed | |
| Brand Driver option | / | |

Driver Datasheet

| Model No. | BQ-YPL-U120-9-T-CCT | BQ-YPL-U175-12-T-CCT |
|--------------------------|---|----------------------|
| Power Type | US standard power supply (Compatible with LEVITON / Lutron dimmers) | |
| Power(W) | 9W | 12W |
| Frequency(HZ) | 60HZ | |
| Input Voltage(V) | AC100-130V | |
| Power Efficiency | ≥87% | |
| Total load wattage(W) | 9W±5% | 12W±5% |
| Power Factor | ≥0.9 | |
| Rated Input Current(A) | ≤0.1A | ≤0.15A |
| Full load output voltage | DC27-30V | DC45-50V |
| Output current range | 280mA±5% | 280mA±5% |
| Power tolerance | ±5% | |
| Current output tolerance | ±5% | |
| Short circuit protection | PASS | |
| Over voltage protection | PASS | |
| Over temperature | PASS | |
| THD | / | |
| Surge | L-N 1000V | |
| Withstand voltage | AC 1500V | |

Installation Procedure

WARNING

1. Switch off before installation.
2. Switch on only after complete installation and examination of the circuit.
3. Professional electrician for installation and maintenance only.



Turn Off power supply before starting any installation. Read instructions & check you have all the tools & accessories to complete the installation correctly.

Recessed into ceiling

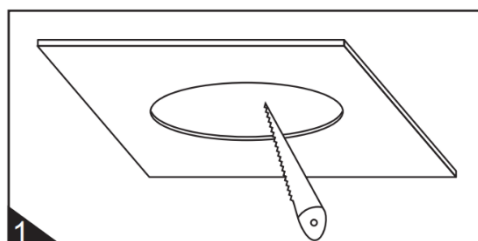

1

According to the cut size to cut the ceiling hole.

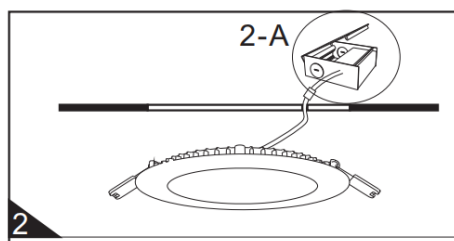

2

Cut off power, the driver wire connected with ceiling wire.

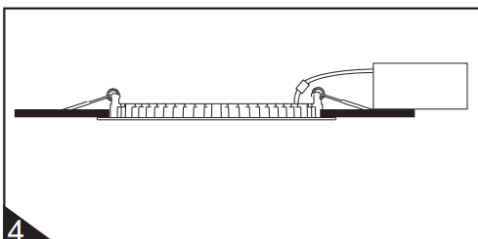

4

Install finishing

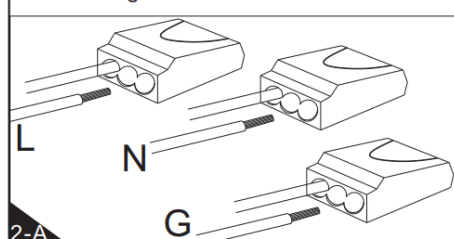

2-A

G

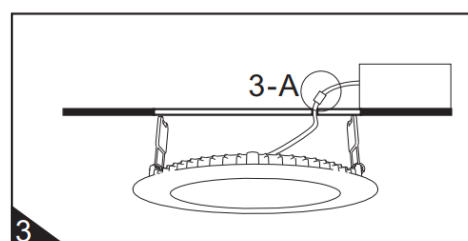

3

Insert panel light into the ceiling hole

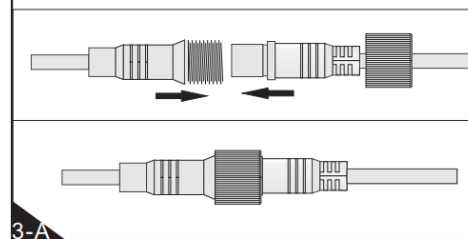

3-A